

Facts at a Glance: THE RESORT AT PORT LUDLOW

A MEETING PLANNER'S GUIDE TO

GOLF COURSE

- Washington's most beautiful course
- 27 holes of championship Golf
- 3 Nines - Tide, Timber, Trail
- #4 Public course in Washington
- "A must play" (Fairways & Greens, Feb '06)
- Uncomparable water and mountain views



THE MARINA

- 300-slip full service Marina
- Guest & Permanent Moorage Slips
- Kayak Rentals
- Side ties for boats up to 200'
- Float Plane Dock
- General Marina Store



RESORT AMENITIES

- Waterfront resort perfect for your meeting
- 37 well-appointed guest rooms
- Fully-furnished condominiums
- Beachside Pintail House and Loft
- 3,000 sq. ft. of meeting space
- Two waterside restaurants
- Teambuilding including geoteaming
- Spa and Golf packages
- Complimentary wireless Internet



IN-ROOM AMENITIES INCLUDE

- Water and mountain views
- Fireplace with sitting area
- Oversized whirl bath jetted tub
- Waffle-weave bathrobes
- European mattress and down-filled duvet
- Remote controlled television and VCR
- Freshly ground in-room coffee and coffee maker
- Refrigerator

RECREATION

- Special rates and playing privileges for guests at the 27-hole Port Ludlow Golf Course
- Sea kayak rentals available
- Bicycle rentals available
- Hiking on trails throughout Port Ludlow or the nearby Olympic National Park
- Skiing or snowshoeing at nearby Hurricane Ridge
- Shopping at Victorian era Port Townsend or Scandinavian-style Poulsbo

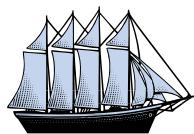

PORT LUDLOW
golf. marina. inn. home.

THE RESORT AT PORT LUDLOW

One Heron Road, Port Ludlow, WA 98365

telephone - 1.888.510.7201 fax - 360.437.7410

e-mail - groupsales@portludlowresort.com website - www.portludlowresort.com

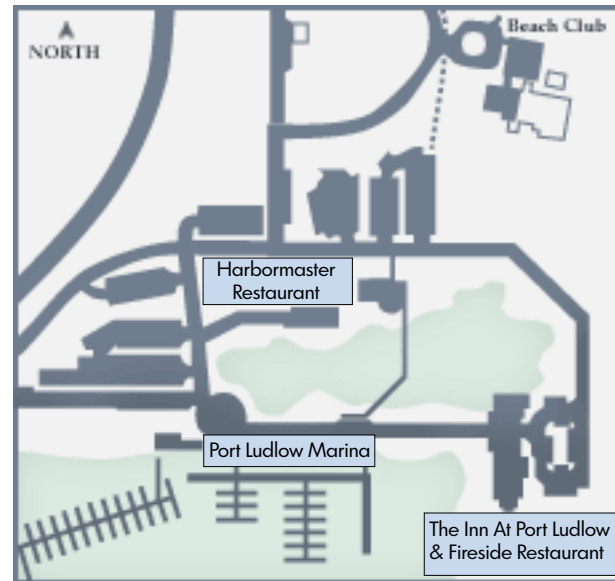

CHECK IN/OUT

Our check-in time is 4 pm and check-out time is 12 pm.

GENERAL

The Inn At Port Ludlow is a non-smoking facility. Smoking is permitted 25 feet from restaurant and entrances.

THE RESORT AT PORT LUDLOW

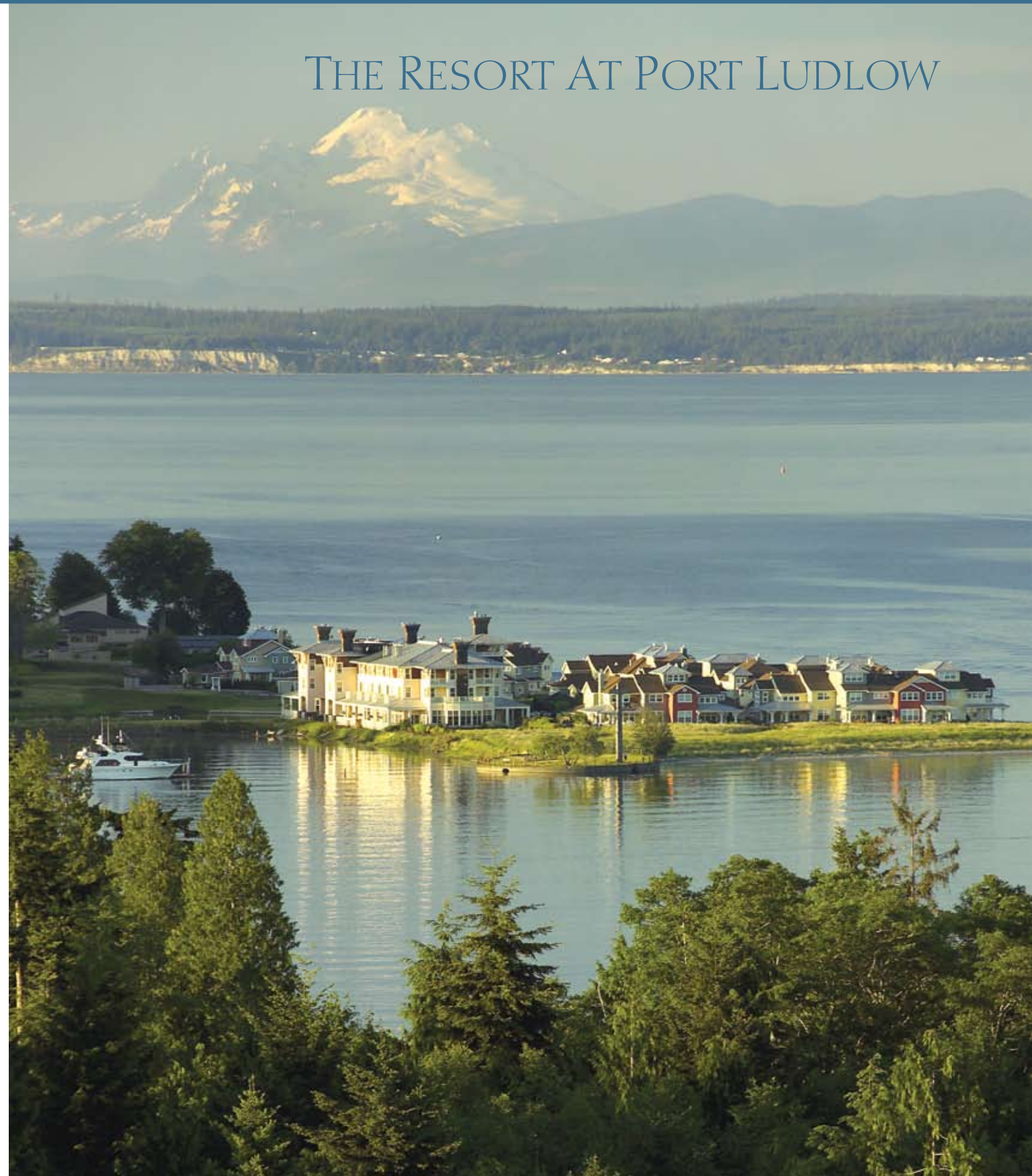

The Inn At Port Ludlow First Floor & Meeting Room Map

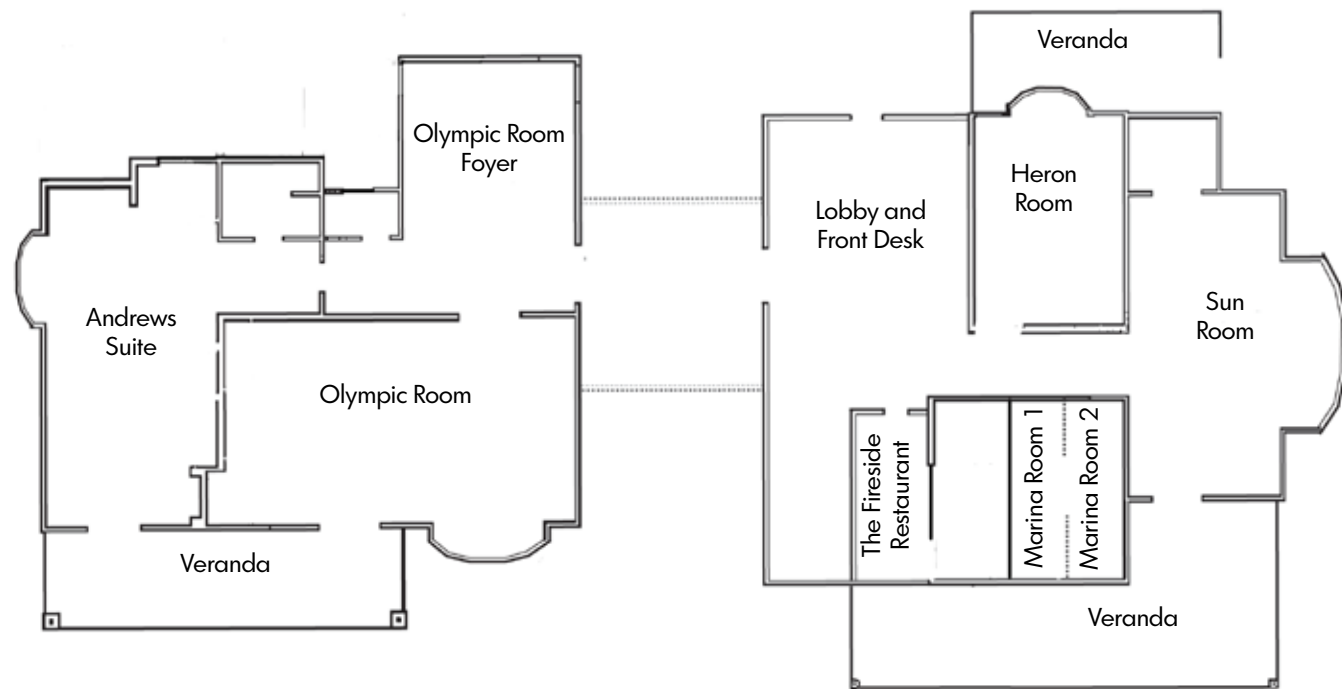

Meeting Facilities Capacity Chart

Room Name	Dimensions	Sq. Ft.	Reception	Banquet	Conf.	Pod/Double Conf.	Theater	Classroom	Round	U-Shape
The Inn At Port Ludlow										
Olympic Room	20'x32'	656	100	60	-	36	70	48	60	32
Heron Room	24'x17'	420	30	30	18	-	40	24	30	18
Andrews Suite	14'x34'	562	20	40	12	-	30	12	40	-
Olympic/Andrews			100	-	-	-	-	-	-	-
Marina Rooms		600	50	40	-	-	-	-	-	-
Harbormaster Rooms										
Compass		405	24	24	-	-	-	-	-	-
Chart		784	60	48	-	-	60	35	48	-

* Other configurations are available on a case by case basis.

Meeting facilities and capacity subject to change without notice. Information current as of August 8, 2006.

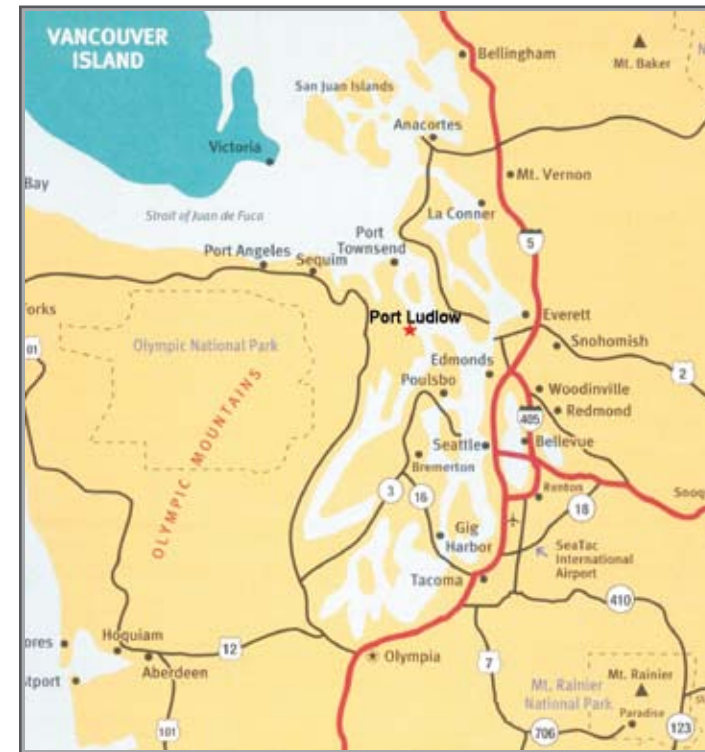

Whether you're planning an executive retreat or a conference, The Resort At Port Ludlow has the facilities and expertise to set the stage for your successful meeting. Located at The Resort, The Inn At Port Ludlow offers nearly 3,000 square feet of meeting space, each featuring large windows providing natural light, water or marina views, high speed wireless internet access, and full audio visual capabilities. Groups can easily walk from guestrooms to meeting rooms located in the same building, or to any location on the grounds. The Inn's New England-styled, fully equipped meeting space accommodates groups of up to 5-60 people in size. Each of the 37 guest rooms with water views, whirljetted tubs and fireplace inspire creativity and relaxation. Located beachfront on the Olympic Peninsula, The Resort At Port Ludlow offers a truly spectacular venue for your next retreat or meeting.

Location. The Resort At Port Ludlow is just 25 minutes from the Edmonds/Kingston ferry, 45 minutes from the Seattle/Bainbridge ferry, and 90 minutes from Sea-Tac International Airport. Rental car, limousine and taxi service from Sea-Tac Airport are available. Or arrive in just 15 minutes by sea-plane from Seattle.

All Inclusive Conference Room Packages

Conference Room Packages include use of the Olympic Room, Heron Room or Andrews Suite, beverage service of coffee, tea, water, and soda and use of all available audio video equipment including an LCD projector, slide projector, screen, podium, microphone and speaker, conference phone, audio CD player, easel pads, notepads and pens, and power strip. All inclusive conference room packages are \$400.



Dining Experience

The Resort At Port Ludlow offers two full service restaurants for your group's dining pleasure. Our Culinary Team is committed to providing the best possible experience for you and your group.

The Fireside is situated in The Inn At Port Ludlow. Dinner is served nightly in an elegant yet informal setting combining the warmth of dark wood, flickering firelight and beautiful scenery. Choose a table near one of our fireplaces, floor to ceiling windows or outside on the veranda with sweeping views of Ludlow Bay and the sun setting over the Olympic Mountains. The Menu reflects the finest in seasonal ingredients from the Pacific Northwest prepared and presented in uncluttered sophistication. Our dishes feature superb cuts of organically raised, local beef and lamb as well as an abundant variety of fresh seafood.

Harbormaster Restaurant is the place to go for casual waterfront dining. Located within walking distance of The Inn and overlooking breathtaking Ludlow Bay, the Harbormaster is dedicated to a fun, family-friendly atmosphere. The new menu features a huge variety of dishes. Appetizers for sharing, Giant Sandwiches and Fresh Signature Salads compliment Steaks, Seafood and Pasta. Homemade desserts and Northwest Wines make this a spectacular dining experience with a view to match.